

## Special single row cylindrical roller bearings for railway vehicle axles

Dimensions								Basic Load Rating	
d	D	B	r <sub>s</sub> min	r <sub>1s</sub> min	d <sub>1</sub>	d <sub>2</sub>	F	Dynamic C <sub>r</sub>	Static C <sub>or</sub>
mm								kN	
100	180	60	2.1	2.1	127.3	-	119	360	490
100	180	60	2.1	2.1	-	127.3	119	360	490
110	215	73	4	4	147	-	135.5	460	650
110	215	73	4	4	-	147	135.5	460	650
118	240	80	3	7.5	160.8	-	150	553	742
118	240	80	3	7.5	-	160.8	150	553	742
119	240	80	3	7.5	160.8	-	150	553	742
119	240	80	3	7.5	-	160.8	150	553	742
119,3	240	80	3	7.5	160.8	-	150	553	742
119,3	240	80	3	7.5	-	160.8	150	553	742
120	200	62	2.1	2.1	148	-	140	371	565
120	200	62	2.1	2.1	-	148	140	371	565
120	215	73	3	2.1	150.8	-	140.5	520	730
120	215	73	3	2.1	-	150.8	140.5	520	730
120	240	80	3	7.5	160.8	-	150	553	742
120	240	80	3	7.5	-	160.8	150	553	742
120	240	80	3	7.5	160.8	-	150	553	742
120	240	80	3	7.5	-	160.8	150	553	742
127	240	80	3	7.5	170.5	-	159	517	752
127	240	80	3	7.5	-	170.5	159	517	752
128	240	80	3	7.5	170.5	-	159	517	752
128	240	80	3	7.5	-	170.5	159	517	752
129	240	80	3	7.5	170.5	-	159	517	752
129	240	80	3	7.5	-	170.5	159	517	752
129	240	80	3	7.5	170.5	-	157	540	775
129	240	80	3	7.5	-	170.5	157	540	775
129,3	240	80	3	7.5	170.5	-	157	540	775
129,3	240	80	3	7.5	-	170.5	157	540	775
130	220	73	3	3	160.2	-	151	500	760
130	220	73	3	3	-	160.2	151	500	760
130	240	80	3	7.5	170.5	-	159	517	752
130	240	80	3	7.5	-	170.5	159	517	752
130	240	80	3	7.5	170.5	-	159	517	752
130	240	80	3	7.5	-	170.5	159	517	752
130	240	80	3	7.5	170.5	-	157	540	775
130	240	80	3	7.5	-	170.5	157	540	775
130	250	80	3	3	172	-	160	580	800
130	250	80	3	3	-	172	160	580	800
160	300	84	4	4	208.7	-	192	870	1215
160	300	84	4	4	-	208.7	192	870	1215

## d = 100 to 160 mm

Bearing Designation	Speed of Rail Vehicle	Weight
	km.h <sup>-1</sup>	kg
PLC 410-57	160	6.7
PLC 410-58	160	6.7
PLC 410-60	160	12.5
PLC 410-61	160	12.5
PLC 410-13.2.3	200	16.2
PLC 410-14.2.3	200	16.2
PLC 410-13.2.4	200	16.1
PLC 410-14.2.4	200	16.1
PLC 410-13.2.5	200	16
PLC 410-14.2.5	200	16
PLC 49-8	120	8.27
PLC 49-9	120	8.27
PLC 410-53.2 <sup>1)</sup>	160	10.4
PLC 410-54.2 <sup>1)</sup>	160	10.4
PLC 410-13	160	16.8
PLC 410-14	160	16.8
PLC 410-13.2	200	16
PLC 410-14.2	200	16
PLC 410-15.2.5	160	14.8
PLC 410-16.2.5	160	14.8
PLC 410-15.2.3	160	14.7
PLC 410-16.2.3	160	14.7
PLC 410-15.2.4	160	14.6
PLC 410-16.2.4	160	14.6
PLC 410-33.2.4	200	15.2
PLC 410-34.2.4	200	15.2
PLC 410-33.2.9	200	15.2
PLC 410-34.2.9	200	15.2
PLC 410-65.2	200	10
PLC 410-66.2	200	10
PLC 410-15	160	15.2
PLC 410-16	160	15.2
PLC 410-15.2	160	14.5
PLC 410-16.2	160	14.5
PLC 410-33.2	200	15.1
PLC 410-34.2	200	15.1
PLC 410-17	160	18.5
PLC 410-18	160	18.5
PLC 411-10	160	28.1
PLC 411-12	160	28.1

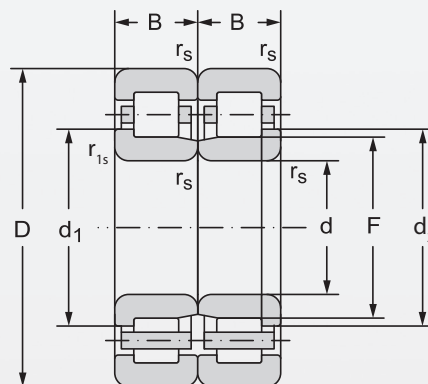

<sup>1)</sup> Shield bearing with metal covers filled with grease